

RADAR URINAL FLUSHING UNITS



RADAR FLUSHING UNITS BENEFITS

We have been manufacturing Radar urinal flushers in our factory for more than 20 years. It is an innovative technology that offers high precision and functionality. Sanela's radar technology senses the movement of liquids inside the urinal and, based on the evaluation of the movement data, flushes whenever it has. Unlike many competing products, the Sanela Radar Flusher is not in contact with water, all detection is through the ceramic and therefore this system excels in durability. This product is also very environmentally friendly and economical as it allows flushing with small amounts of water, where this parameter is easily adjustable. Since 2023, we have implemented Bluetooth technology in our Radar flushers, which makes it possible to set many different parameters using only a mobile phone (Sanela Control app).



SETTING PARAMETERS BY BLUETOOTH

WITHOUT DISASSEMBLING THE DEVICE (PAID SANELA CONTROL APP AVAILABLE FOR DOWNLOAD ON THE APP STORE AND GOOGLE PLAY)



AUTOMATIC FLUSHING AFTER EACH USE OF THE URINAL

SYSTEM ANALYSES CHANGES, WHICH ARE PROCEEDED INSIDE OF THE URINAL



ECONOMY FLUSHING BY 1 LITER OF WATER

CAN BE EVEN LOWER IF THE SIPHON OR URINAL ALLOWS IT (ADJUSTABLE PARAMETER)



VANDAL-PROOF

HIGHLY RESISTANT TO WEAR AND MECHANICAL DAMAGE



CLEAN DESIGN

MOST OF THE ARCHITECTS CHOOSE HIDDEN FLUSHING



EXTENDED 5 YEARS GUARANTEE

ON THE PROPER FUNCTION OF THE ELECTRONICS



ADJUSTMENT OF PARAMETERS BY REMOTE CONTROL

PARAMETERS ARE POSSIBLE TO ADJUST WITHOUT DISASSEMBLY OF THE URINAL



HYGIENIC FLUSH

AUTOMATIC FLUSHING AFTER EACH 6 HOURS NON-USE (ADJUSTABLE PARAMETER)



WATER OVERFLOW PROTECTION



EASY INSTALLATION



LONG LIFE

UP TO THREE LIFE OF THE STANDARD PRODUCTS



MADE IN EUROPE



PLUG & PLAY

EASY INSTALLATION, JUST CONNECT WATER AND ELECTRICITY

URINALS WITH RADAR FLUSHING UNIT **PLUG & PLAY**

URINAL FELIX WITH THE RADAR FLUSHING UNIT, (PLUG & PLAY)



| | | |
|----------|-------|----------|
| SLP 07RS | 11075 | 24 V DC |
| SLP 07RZ | 01075 | 230 V AC |
| SLP 07RB | 11077 | 6 V |

URINAL GOLEM WITH THE RADAR FLUSHING UNIT, (PLUG & PLAY)



| | | |
|---------|-------|----------|
| SLP 19S | 01196 | 24 V DC |
| SLP 19Z | 01197 | 230 V AC |
| SLP 19B | 21195 | 6 V |

URINAL ALEX WITH THE RADAR FLUSHING UNIT, (PLUG & PLAY)



| | | |
|----------|-------|----------|
| SLP 18RS | 11185 | 24 V DC |
| SLP 18RZ | 01185 | 230 V AC |
| SLP 18RB | 11187 | 6 V |

URINAL CAPRINO WITH THE RADAR FLUSHING UNIT, (PLUG & PLAY)



| | | |
|---------|-------|----------|
| SLP 23S | 01233 | 24 V DC |
| SLP 23Z | 01234 | 230 V AC |
| SLP 23B | 01232 | 6 V |

URINAL CAPRINO PLUS RIMLESS WITH THE RADAR FLUSHING UNIT, (PLUG & PLAY)



| | | |
|---------|-------|----------|
| SLP 49S | 01498 | 24 V DC |
| SLP 49Z | 01499 | 230 V AC |
| SLP 49B | 01492 | 6 V |

URINAL WCA WITH THE RADAR FLUSHING UNIT, (PLUG & PLAY)



| | | |
|----------|-------|----------|
| SLP 82RS | 01820 | 24 V DC |
| SLP 82RZ | 01822 | 230 V AC |
| SLP 82RB | 01821 | 6 V |

URINALS WITH RADAR FLUSHING UNITS

URINAL LEMA RIMLESS WITH THE RADAR FLUSHING UNIT



| | | |
|----------|-------|----------|
| SLP 59RS | 11596 | 24 V DC |
| SLP 59RZ | 01595 | 230 V AC |
| SLP 59RB | 11597 | 6 V |

BLACK URINAL LA FONTANA WITH THE RADAR FLUSHING UNIT



| | | |
|---------|-------|----------|
| SLP 89S | 01890 | 24 V DC |
| SLP 89Z | 01891 | 230 V AC |

URINAL VILA WITHOUT COVER WITH THE RADAR FLUSHING UNIT



| | | |
|----------|-------|----------|
| SLP 12R | 01124 | 24 V DC |
| SLP 12RZ | 01125 | 230 V AC |
| SLP 12RB | 11127 | 6 V |

URINAL VILA WITH COVER (SYSTEM SOFT-CLOSE) AND WITH A RADAR FLUSHING UNIT



| | | |
|----------|-------|----------|
| SLP 37R | 01374 | 24 V DC |
| SLP 37RZ | 01375 | 230 V AC |
| SLP 37RB | 11377 | 6 V |

URINAL ARQ WITH COVER AND WITH THE RADAR FLUSHING UNIT



| | | |
|----------|-------|----------|
| SLP 32R | 01324 | 24 V DC |
| SLP 32RZ | 01325 | 230 V AC |
| SLP 32RB | 11327 | 6 V |

URINAL LIVO WITH THE RADAR FLUSHING UNIT



| | | |
|----------|-------|----------|
| SLP 31RS | 11315 | 24 V DC |
| SLP 31RZ | 01315 | 230 V AC |
| SLP 31RB | 11317 | 6 V |

RADAR FLUSHING UNITS



RADAR FLUSHING UNIT FOR

- (GEBERIT) NOVA PRO FELIX 26 000;
- NOVA PRO ALEX 66 000;
- RENOVA NR. 11 235 300;
- NOVA PRO M36 000;
- RENOVA NR.1 PLAN 235 100 (KOLO);
- SELNOVA 500 344

| | | |
|---------|-------|----------|
| SLP 07S | 11071 | 24 V DC |
| SLP 07Z | 01071 | 230 V AC |
| SLP 07B | 11076 | 6 V |



RADAR FLUSHING UNIT FOR

- (OLYMPIA) OLYMPIA ORI50101

| | | |
|---------|----------|----------|
| SLP 99S | ORI50101 | 24 V DC |
| SLP 99Z | ORI50101 | 230 V AC |
| SLP 99B | ORI50101 | 6 V |



RADAR FLUSHING UNIT FOR

- (VILLEROY & BOCH) SUBWAY 751300, 751301, 751305

| | | |
|----------|-------|----------|
| SLP 71RS | 11715 | 24 V DC |
| SLP 71RZ | 11716 | 230 V AC |
| SLP 71RB | 11717 | 6 V |



RADAR FLUSHING UNIT FOR

- (GSI) COMMUNITY 31x35 909811, 909826, 909817, 909809, 909711, 909726, 909717, 909709

| | | |
|---------|-----------------|----------|
| SLP 99S | Community 31x35 | 24 V DC |
| SLP 99Z | Community 31x35 | 230 V AC |
| SLP 99B | Community 31x35 | 6 V |



RADAR FLUSHING UNIT FOR

- (LAUFEN) VAL 840281, 840285

| | | |
|-------------|------------|---------|
| SLP 99S VAL | VAL 840281 | 24 V DC |
| SLP 99B VAL | VAL 840281 | 6 V |



RADAR FLUSHING UNIT FOR

- (DURAVIT) VIU 281630, 281632

| | | |
|---------|--------------------|----------|
| SLP 99S | VIU 281630, 281632 | 24 V DC |
| SLP 99Z | VIU 281630, 281632 | 230 V AC |
| SLP 99B | VIU 281630, 281632 | 6 V |



RADAR FLUSHING UNIT FOR

- (IDEAL STANDARD) SIMPLICITY E8772

| | | |
|---------|------------------|----------|
| SLP 99S | Simplicity E8772 | 24 V DC |
| SLP 99Z | Simplicity E8772 | 230 V AC |
| SLP 99B | Simplicity E8772 | 6 V |



RADAR FLUSHING UNIT FOR

- (HATRIA) FUSION YXE1 (YXC3)

| | | |
|---------|--------------------|----------|
| SLP 99S | Fusion YXE1 (YXC3) | 24 V DC |
| SLP 99Z | Fusion YXE1 (YXC3) | 230 V AC |
| SLP 99B | Fusion YXE1 (YXC3) | 6 V |

SANELA PRODUCTS APPLICATIONS

The use of the system **modernises** the building and increases its utility value.



AUTOMATIC WASHBASIN
TAPS

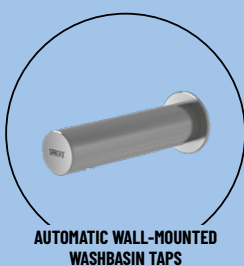

AUTOMATIC WALL-MOUNTED
WASHBASIN TAPS



RADAR URINAL
FLUSHING UNITS



AUTOMATIC TOILET
FLUSHING UNITS



AUTOMATIC SHOWER CONTROLS
AND URINAL FLUSHING UNITS

Examples of buildings where the **use of radar technology** is clearly beneficial.
But it can also be used in other places, **there are no limits.**

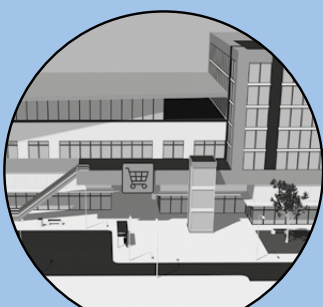

SHOPPING CENTRE



OFFICE BUILDING

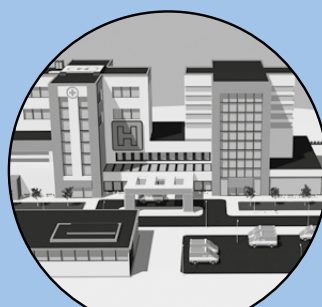

HOSPITAL

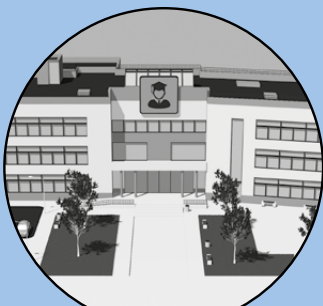

SCHOOL

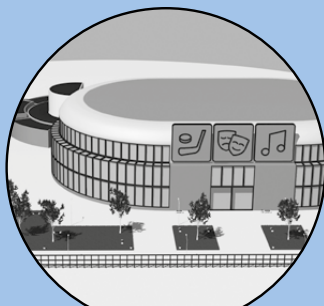

CULTURAL AND SPORTS CENTRE

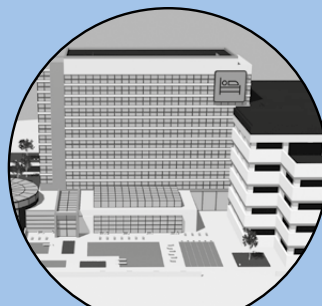

HOTEL

SANELA CONTROL APP

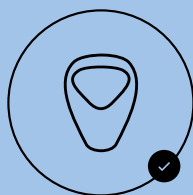

EASY
ACCESS

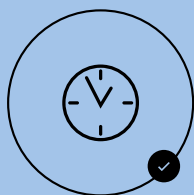

TIME
SAVINGS



DEVICE
PROTECTION

With this application, it is possible to quickly and efficiently set individual parameters for SANELA devices that contain a Bluetooth communication module. This application replaces the SLD remote controls. By starting the application, all SANELA devices with a Bluetooth module that are located nearby are automatically searched for.



FLUSH TIME

Can be set from 0.5 to 15.5 seconds. The customer can choose the optimal time himself, either for high water saving or for better hygiene.

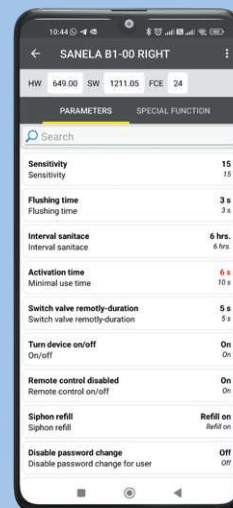

ACTIVATION TIME (MINIMUM USE TIME)

This is the minimum time the urinal must be used so that the Radar activates the flush. It is factory set at 10 seconds, but in specific installations such as kindergartens, elementary schools or elderly homes, this time can be reduced to a minimum of 6 seconds. This ensures correct flushing in all cases.

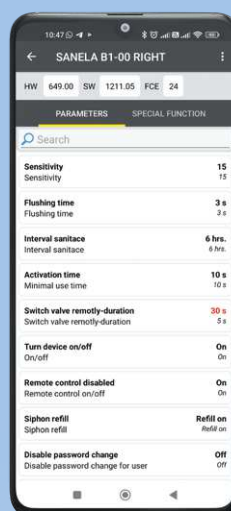

SWITCH VALVE ON REMOTELY (CLEANING MODE)

One press can activate flushing from 5-1200 seconds. Can be used when cleaning urinals, the cleaner can use enough water to perform a proper cleaning.

NEXT FUNCTIONS:



RENAME DEVICE

You can choose a custom name for each Radar to make it easier to identify for later parameter changes.



ENTER A NEW PASSWORD

You can password-protect each Radar so that no one can access it.



SANITATION INTERVAL

You can choose after how long without using the urinal is automatically flushed.



FACTORY SETTINGS

If you want to go back to the parameters set in our factory, it is possible with one press.

PAID APP AVAILABLE ON



We manufacture our Radar technology for many other types of ceramic urinals. Therefore, if you are interested, please do not hesitate to contact us to see if a radar flusher is available for your type of urinal.



SANELA spol. s r.o.

Dukelských hrdinů 989 • 563 01 Lanškroun, Czech Republic

tel.: +420 465 350 770-1

e-mail: sanela@sanela.cz

www.sanela.eu



EN ISO 9001:2015